

# DISTANCE GIRDER

## PURPOSE OF USE

Used for fast and easy fixing of distance of reinforcement. Used in case of higher loads. Ensures solid and stable footing for concrete casting works.

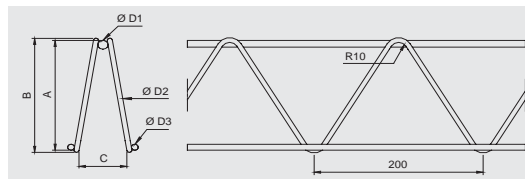
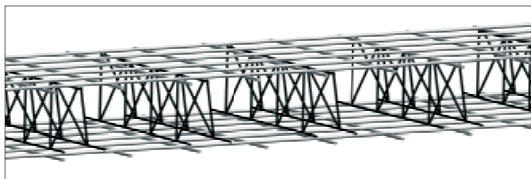

### Consumption of the distance girder per square metre

Load endurance of the evenly distributed distance girders

Distance between girders	Load endurance	Consumption per square metre
1 m	120 kg/m <sup>2</sup>	1.00 jm/m <sup>2</sup>
0.8 m	150 kg/m <sup>2</sup>	1.25 jm/m <sup>2</sup>
0.6 m	200 kg/m <sup>2</sup>	1.10 jm/m <sup>2</sup>
0.4 m	300 kg/m <sup>2</sup>	2.50 jm/m <sup>2</sup>

### Distance girder

A	Design height	110 – 300 mm
B	Overall height	A+7 mm max
C	Width of the girder	70 – 100 mm
D1	Upper chord	6 – 8 mm
D2	Diagonals	5 – 6 mm
D3	Lower chord	5 – 8 mm
	Pitch of diagonals	200 mm
L	Length	2000 mm