

FORMWORK MOULDS

MAIN ADVANTAGES COMPARED TO WOODEN FORMWORK:

FASTER // CHEAPER // NO NEED TO REMOVE FORMWORK // CONSTRUCTION SITE REMAINS CLEAN



EESTI TRAAAT



REINFORCEMENT

TECHNICAL DATA *////////////////////*

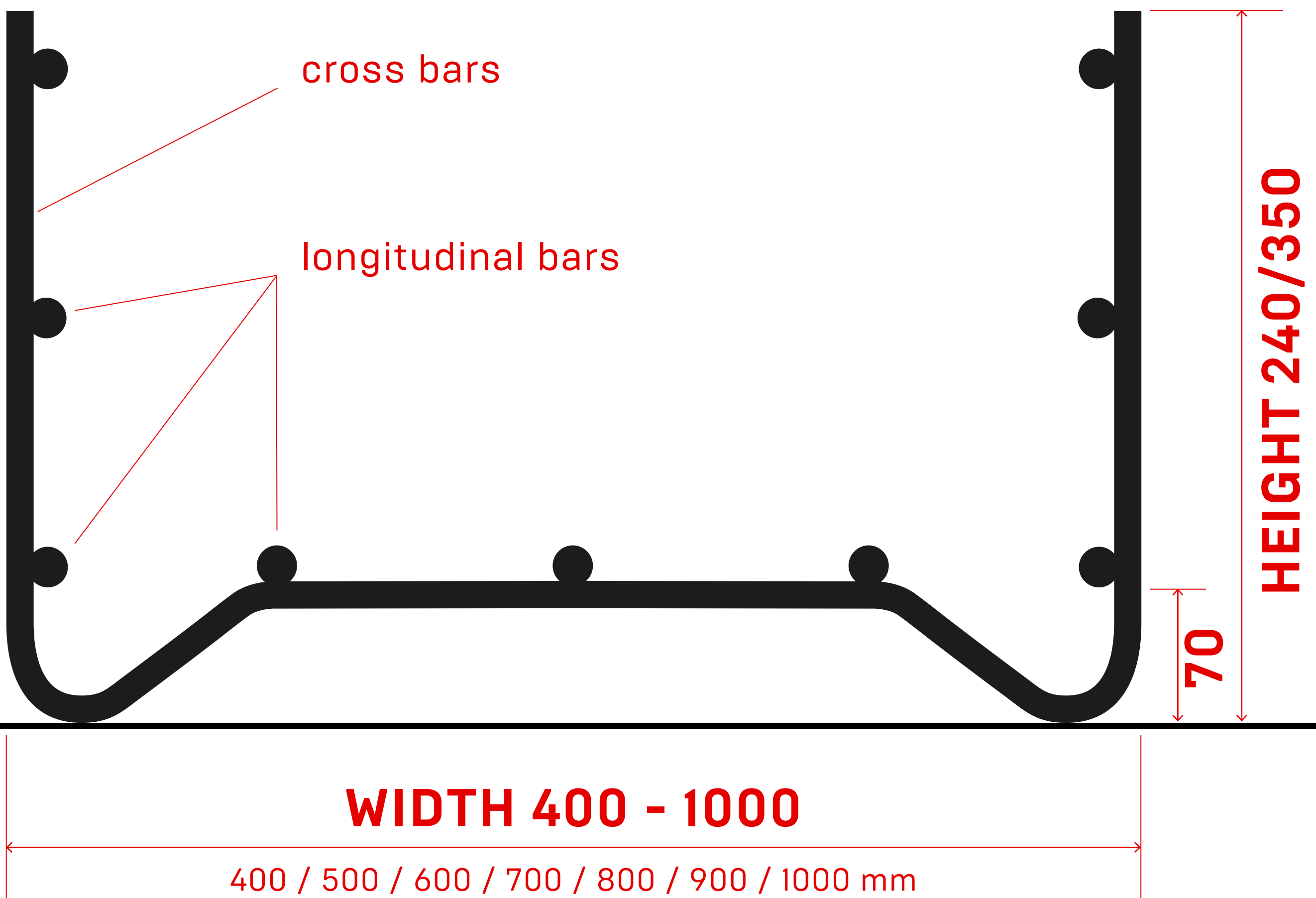

LENGTH **6,0 m**

GROUND CLEARANCE OF BOTTOM BARS **70 mm**

REBARS **3 x \varnothing 8 mm, yield strength 500 N/mm²**

CROSS BARS **\varnothing 6 mm, spacing 200 mm**



INSTALLATION INSTRUCTIONS // // // //

REQUIRED FOR INSTALLATION OF FORMWORK MOULDS:

Rebar cutters, knife, rebar tie hook and binding wire, measuring tape and a couple of hours of your time. For calculating the required quantity of formwork moulds, add extra 10% for joints and overlaps.

- / Use spray paint to mark the contours of the future building on compacted gravel.
- // Start installation at the furthest corner.
- /// First put in place full length moulds, then add missing sections.
- //// Tie the joints.
- ///// Place the bottom edge of plastic sheeting under the moulds.
- /////// Apply height markings on the inside of moulds for pouring concrete.
- //////// Pour concrete up to the height markings.

The moulds are designed for pouring 20cm of concrete - if the layer is thicker, the mould walls will bend outwards by up to 3cm at the top. This means additional concrete consumption of approx. 0.5m³ per 100 meters of mould. The following drawings show some standard solutions for joints. You can also make steps, inclinations, bends and extension pockets (for chimney foundation or the like).

CUTTING POSITION FOR CROSS BARS / USE OF RETENTION HOOKS

To reduce concrete loss and prevent the top edge of moulds from bending outwards we recommend using retention hooks with a 1m spacing.

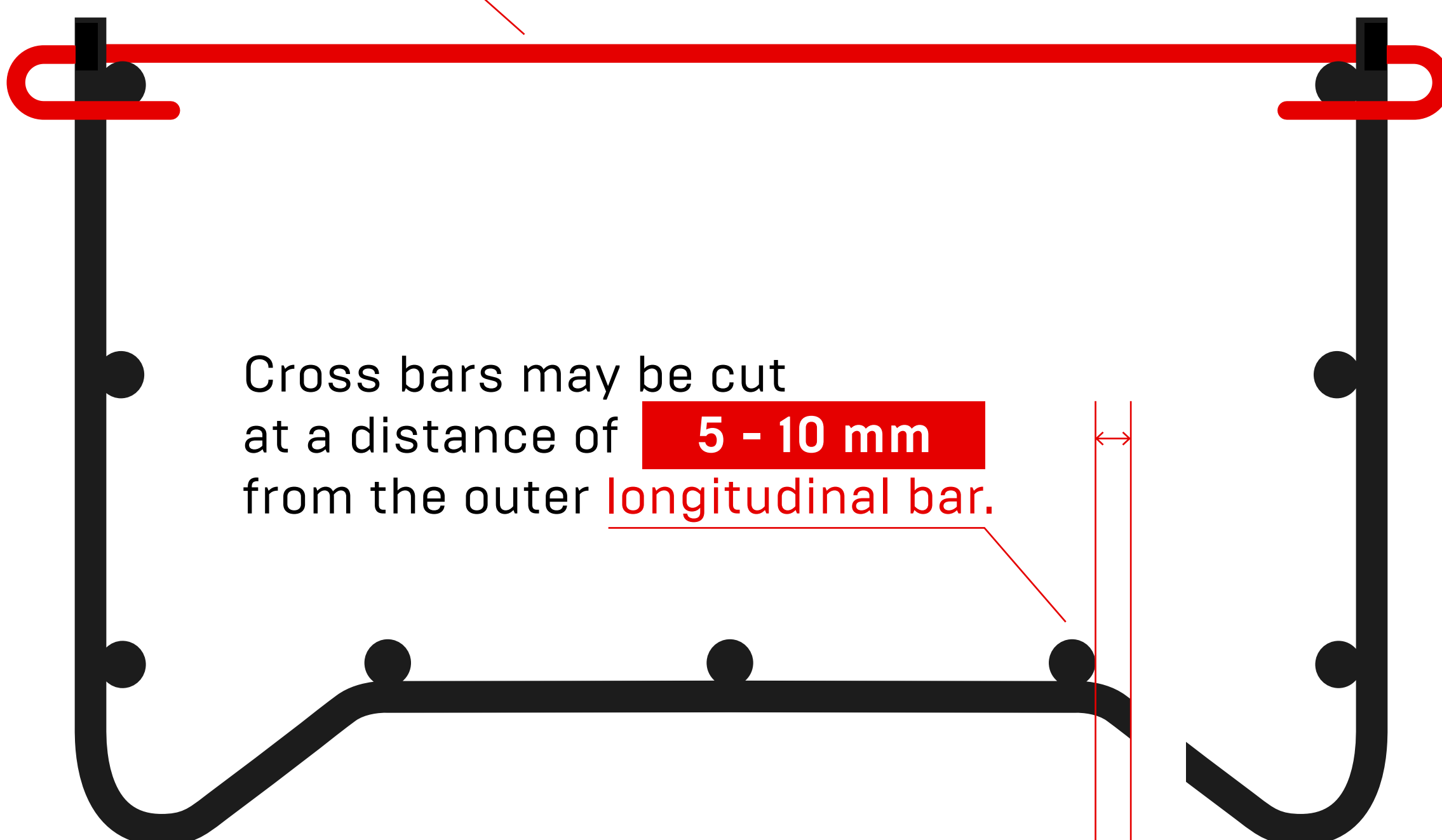

CORNER JOINT

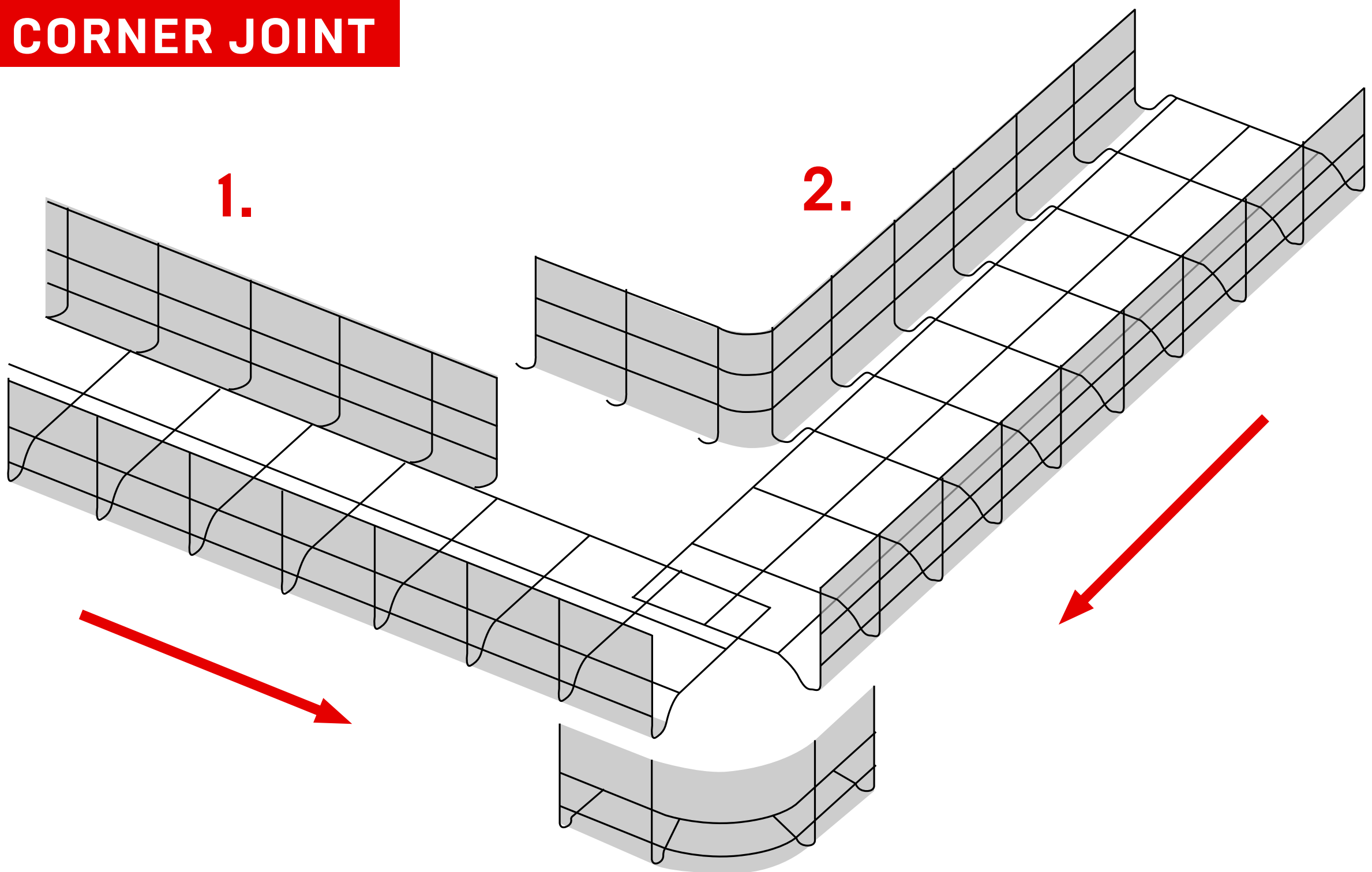

- / Place the formwork moulds on the contour markings to identify cutting and bending positions.
- // Cut and bend as per above drawing (note the cutting position of cross bars).
- /// Place mould **1.** on top of mould **2.**
- //// Put the cutout under the outer corner so that the cross bar hooks remain under the mould.

T-JOINT

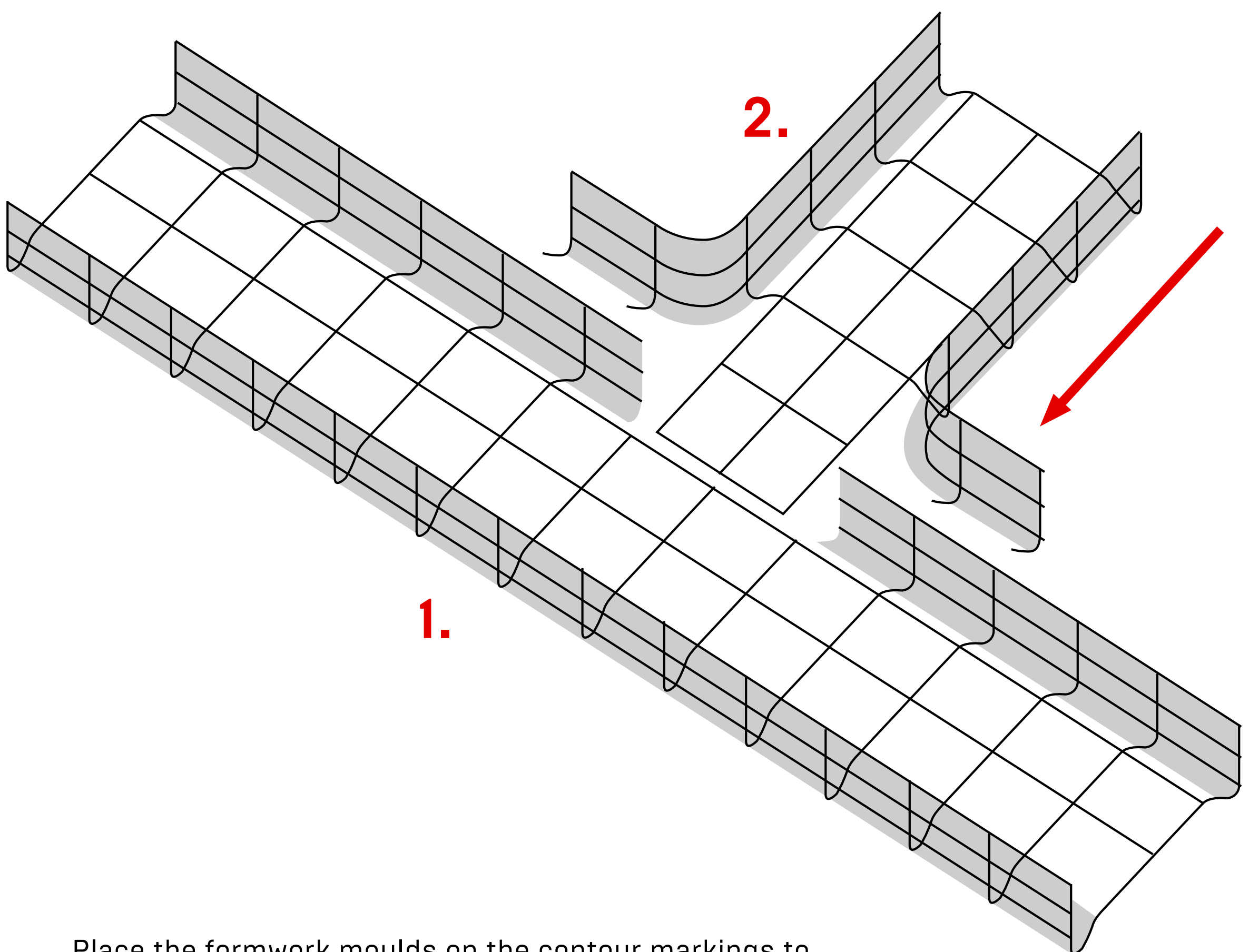

- / Place the formwork moulds on the contour markings to identify cutting and bending positions.
- // Cut and bend as per above drawing.
- /// Place mould **1.** under mould **2.**



EXTENSION JOINT

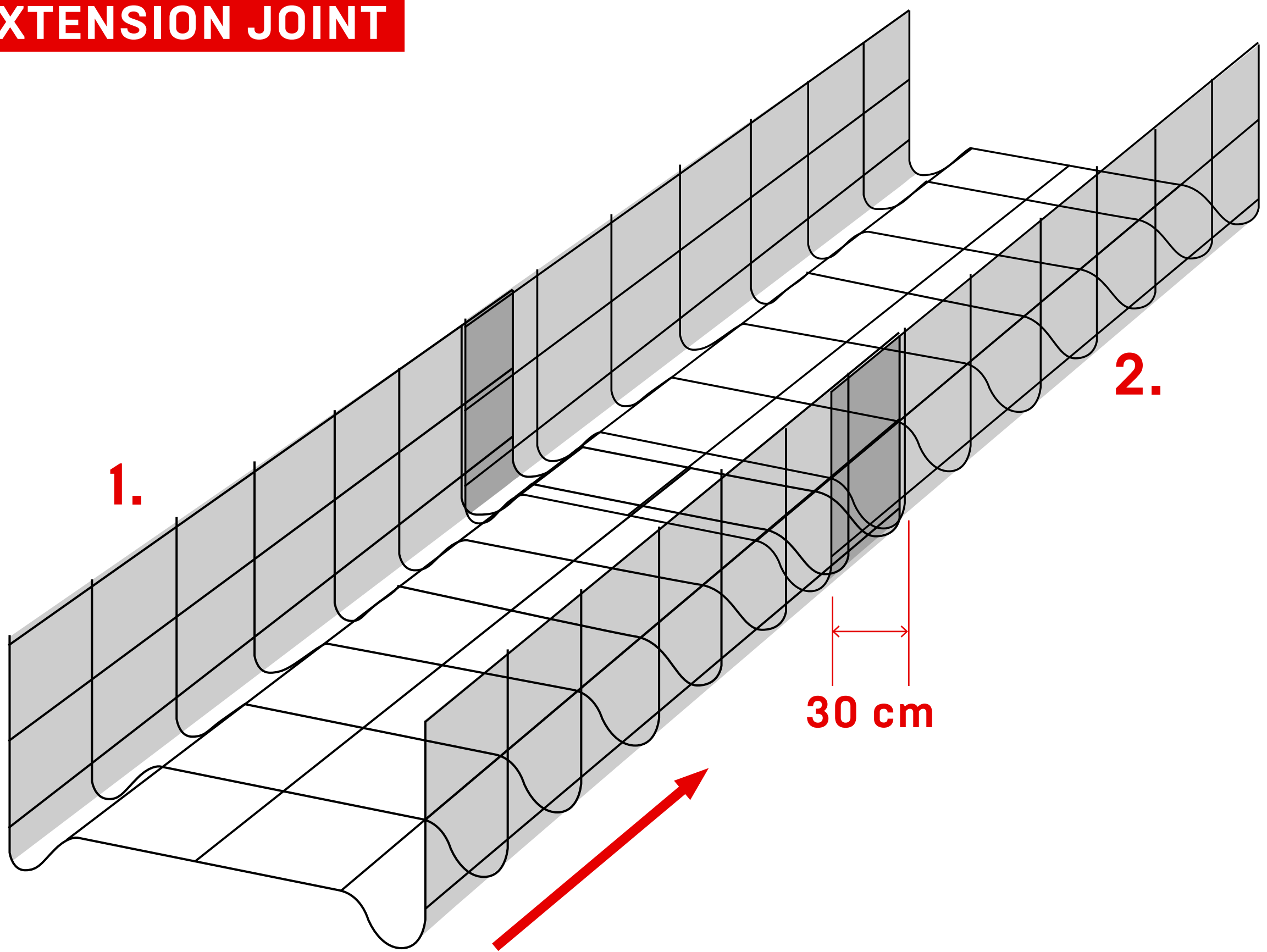

- / Cut the first two cross bars of mould **2.** at the centre.
- // Place mould **1.** inside mould **2.** with an overlap of **30 cm.**
- /// Press all the way down.

POST FOOTING

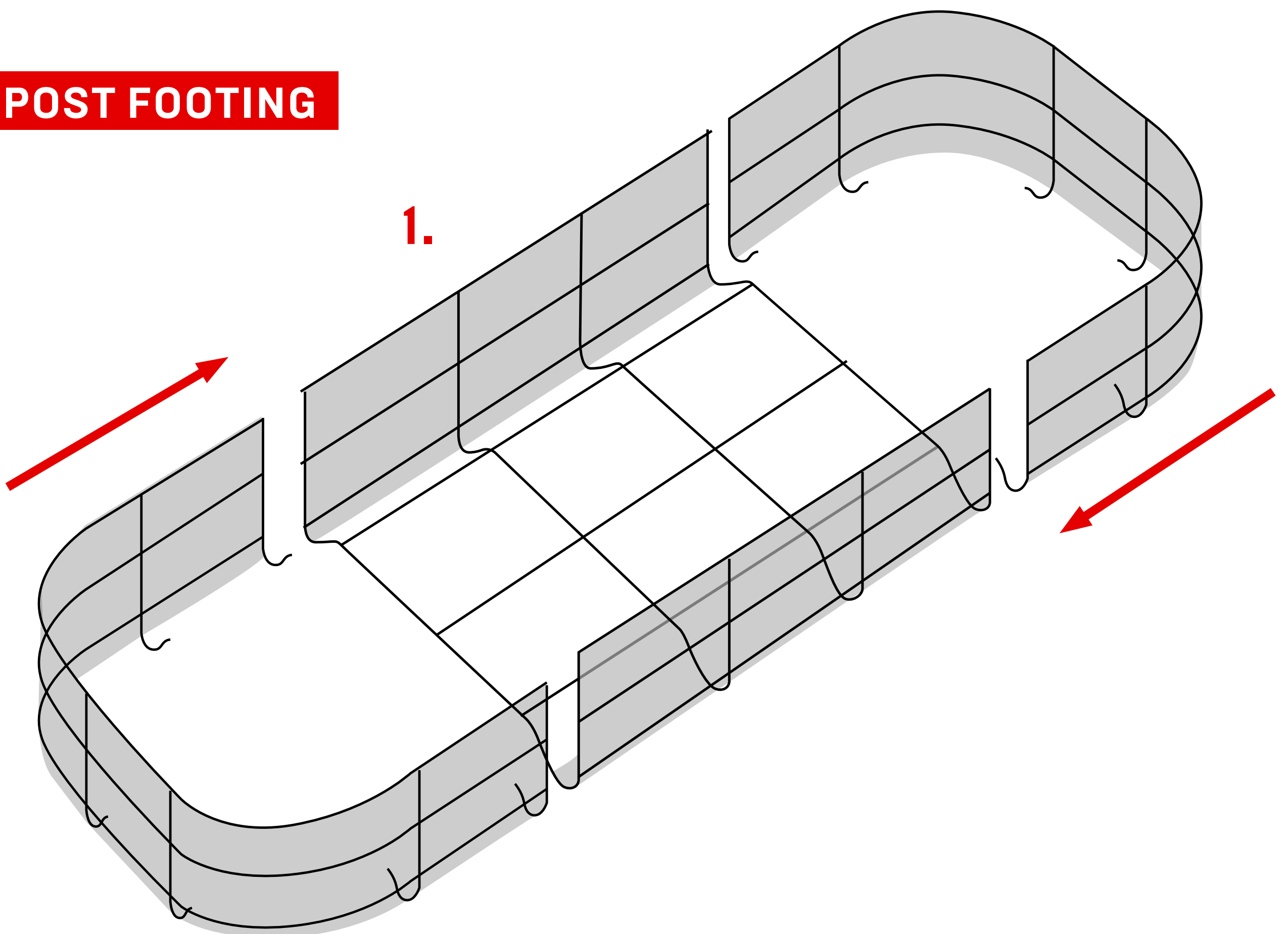

- / Cut the mould to size.
- // For forming the ends, cut a piece that is at least **50 cm** longer than the width of mould.
- /// Form the end pieces as per above drawing.
- //// Place the end pieces under the mould.